

RAUCH

Phone: (718) 507-8844 Fax: (718) 565-6018
 Email: info@irauch.com
 Address: 32-20 112th St, East Elmhurst, NY 11369

Fig 137: Adjustable Pipe Saddle Support



Material: Steel
Service Application: Adjustable Pipe Supports are used in conjunction with a pipe standard and flange at the base, to support piping where an overhead supporting member is not available. The stem is threaded its full length, with a nut to allow a vertical adjustment to take care of the pitch in the pipe line.
Finish: Black, galvanized or painted.
Ordering: Specify size, figure number and finish.

FIG 137

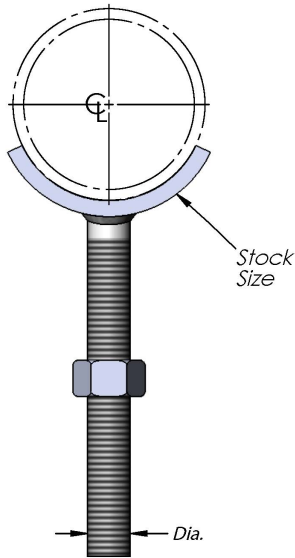

PIPE SIZE	STEEL SIZE	DIAMETER & STEM LENGTH	WT/C APROX
2	3/8 x 1 1/2	7/8 x 8	192
3	3/8 x 1 1/2	7/8 x 8	220
4	3/8 x 2	1 x 8	323
5	3/8 x 2	1 x 8	367
6	1/2 x 2	1 1/4 x 8	592
8	1/2 x 2	1 1/4 x 8	677
10	1/2 x 3	1 1/2 x 8	1156
12	1/2 x 3	1 1/2 x 8	1308

PROJECT INFORMATION	APPROVED
JOB:	NOTES:
ADDRESS:	
CONTRACTOR:	
ENGINEER:	
DATE:	
APPROVED _____ NOT APPROVED _____ APPROVED AS NOTED _____	