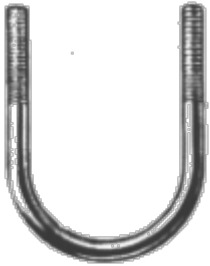

**Fig 223: Light Duty U-Bolt**



**Material:** Steel  
**Service Application:** General piping.  
**Finish:** Black or galvanized.  
**Ordering:** Specify size, figure number and finish.

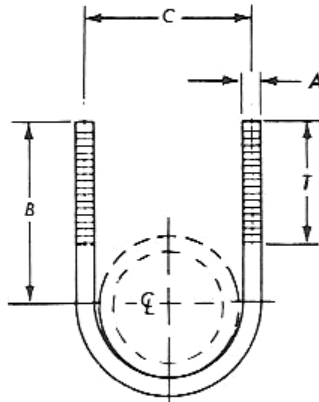

FIG 223

PIPE SIZE	A	B	C	T	WT/C APROX	MAX REC'M
1/4	1/4	1	13/16	1/2	3	485
3/8	1/4	1 1/8	15/16	1/2	4	485
1/2	1/4	1 3/16	1 1/8	1/2	5	485
3/4	1/4	1 3/8	1 3/8	3/4	6	485
1	1/4	1 5/8	1 5/8	3/4	6	485
1 1/4	1/4	1 3/4	1 15/16	3/4	7	485
1 1/2	1/4	1 7/8	2 1/4	1	8	485
2	1/4	2 3/16	2 11/16	1	9	485
2 1/2	3/8	2 7/16	3 5/16	1	26	1220
3	3/8	2 3/4	3 15/16	1 1/4	29	1220
3 1/2	3/8	3	4 7/16	1 1/4	33	1220

PROJECT INFORMATION	APPROVED
JOB:	NOTES:
ADDRESS:	
CONTRACTOR:	
ENGINEER:	
DATE:	
APPROVED _____ NOT APPROVED _____ APPROVED AS NOTED _____	